



Applications

Parking lot
Wall Pack
Roadway
Billboard

Certification

KC
UL
FCC
DLC

Description

Easy Replace & Install
High Luminous Efficacy 125 lm/W
Wireless Lighting Control

Specifications

Model Name	WP050	
Power Consumption	50W	
Correlated Color Temperature	5000K (3500K / 4000K / 6500K available)	
Luminous Flux *	6,250 lm	
Luminous Efficacy *	125 lm/W	
LED Driving Current *	83.3 mA	
Color Rendering Index	80 Ra	
Light Distribution	Asymmetric Wide	
BUG Rating	B1 – UX – G1 (Backlight – Uplight – Glare)	
LED Chip Manufacturer	SAMSUNG	
Input Voltage	100 - 277 Vac	
Input Current	Max 0.6A (@100Vac)	
Power Factor	≥0.9 at Max load	
Frequency	50 ~ 60 Hz	
Driver Type	Constant Current (CC)	
Driver Manufacturer	KMW INC. / Made in Korea	
Size (W x L x H)	15.4 x 9.5 x 4.4 (inch)	390 x 242 x 110.5 (mm)
Weight (Driver included)	7.1 lb	3.2 Kg
Material	Body	Cast Aluminum
	Optic	Silver Coating Reflector
	Cover	Tempered Glass 3.2T (Clear)
Finish	Powder Coating	
IP Rating	IP66	
Mounting Option	Wall Mount, Swivel Bracket, Pole Mount	
Operating Temperature	-22°F ~ 140°F	-30°C ~ 60°C
Life Time	50,000 Hours (@77°F / 25°C)	
Warranty	5 Years (12 hours usage per day)	

Option

Control System	Wireless (ZigBee) / Sensor (Daylight)
Surge Protection	Line-Line 20KV, Line-FG 20KV

*Tolerance : ± 5%

Photometry

See photometric .ies files for details.

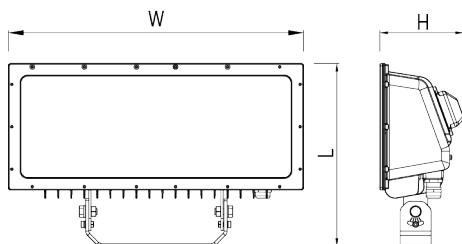

Swivel Type

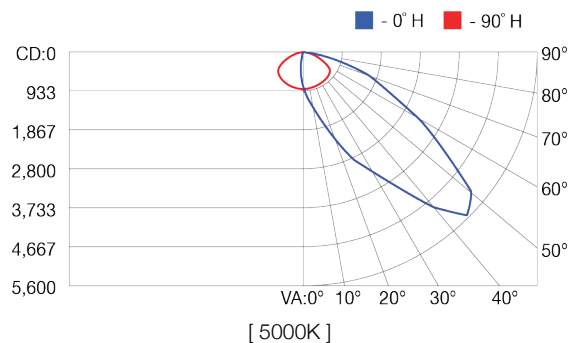

Control Specification (Optional)

ZigBee (Mesh Networking)		Wireless Control
Input Voltage		15 Vdc
Max. Power Consumption		0.3 W (@15Vdc)
Standard		2.4 GHz - IEEE 802.15.4 (Compatible)
Network		Mesh
RF Tx Power		Max. +8 dBm (Typ. 5 dBm)
Data Rate		250 kbps
Security		128 bit AES Encryption Algorithms
Dimmer		PWM, 0 – 10 Vdc
Antenna		Omni Type, 2 dBi
Daylight Sensor		Smart sensor Module
Operating Voltage Range		5 – 50 Vdc (TYP. 15 Vdc)
Max. Power Consumption		0.6 W (@15Vdc)
Detectable Illumination Range		9.2 – 92 fc (Default : 64 fc) / 100 – 1,000 lx (Default : 700 lx)
LED Light Bi-level Setting		0 % to 30 % (Adjustable) / 10% (Default)
Output Signal		PWM

Ordering Information

Order Code Usage : WP050-A50WMNG1S

	000	-	O	OO	OO	O	OO	O
	Power Consumption		Input Voltage	CCT(K)	Installation Type	Dimming control & Sensor	Fixture Color	Surge Protector
WP	050=50W 075=75W 100=100W		A=100~277V B=100~240V	35=3500K 40=4000K 50=5000K 65=6500K	WM=Wall Mount MB=Mount Bracket PH=Pole Mount Horizontal PV=Pole Mount Vertical	A=Daylight Sensor Z=ZigBee N=None	G1=Gray Powder	S=Yes Black=No