



Applications

Expressway
Highway
Street

Certification

CE
UL
FCC
DLC
PSE

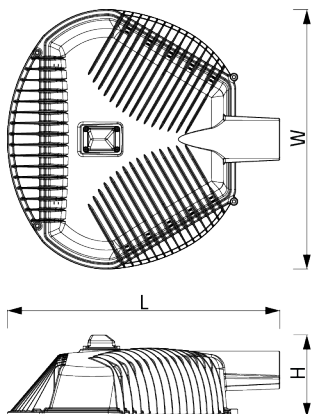

Description

High Efficacy
Excellent Light Distribution and Uniformity
Wireless / Built-in 20KV Surge Protection Device.

Specifications

Model Name	MT100	
Power Consumption	100W	
Correlated Color Temperature	5000K (4000K available)	
Luminous Flux *	13,000 lm	
Luminous Efficacy *	130 lm/W	
LED Driving Current *	71.4 mA	
Color Rendering Index	80 Ra	
Light Distribution	Type III-S	
BUG Rating	B3 - U2 - G3 (Backlight - Uplight - Glare)	
LED Chip Manufacturer	SAMSUNG	
Input Voltage	100 - 277 Vac	
Input Current	Max 1.25A (@100Vac)	
Power Factor	≥0.9 at Max load	
Frequency	50 ~ 60 Hz	
Surge Protection	Line-Line 20KV, Line-FG 20KV	
Driver Type	Constant Current (CC)	
Driver Manufacturer	KMW INC. / Made in Korea	
Size (L x W x H)	19.9 x 18.9 x 6.0 (inch)	505 x 480 x 152.8 (mm)
Weight (Driver included)	17.6 lb	8.0 Kg
Material	Body	Cast Aluminum
	Optic	Silver Coating Reflector
	Cover	Tempered Glass 4.0T (Clear)
Finish	Powder Coating	
Protection	IP Rating	IP66
	IK Rating	IK08
Mounting Option	Horizontal Tenon Mount	
Mount Hole	Ø2.38 inch Pipe Applied	Ø60.5 mm Pipe Applied
Operating Temperature	-22°F ~ 140°F	-30°C ~ 60°C
Life Time	50,000 Hours (@77°F / 25°C)	
Warranty	5 Years (12 hours usage per day)	

Option

Control System	Wireless (ZigBee) / Sensor (Daylight)
Junction Box	Horizontal Tenon Mount

*Tolerance : ± 5%

Photometry

See photometric .ies files for details.

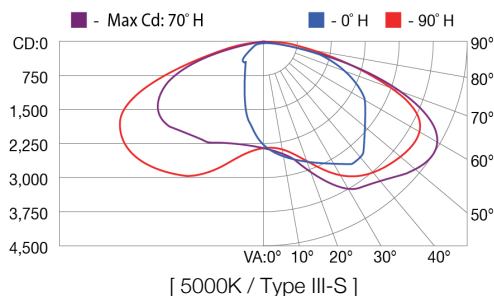

Control Specification (Optional)

ZigBee (Mesh Networking)		Wireless Control
Standard		2.4 GHz – IEEE 802.15.4 (Compatible)
Network		Mesh
RF Tx Power		Max. +8 dBm (Typ. 6 dBm)
Data Rate		250 kbps
Security		128 bit AES Encryption Algorithms
Dimmer		PWM, 0 – 10 Vdc
Antenna Gain		Omni Type, 2 dBi
Input Voltage		15 Vdc
Max. Power Consumption		0.3 W (@15Vdc)
Daylight Sensor		Smart Sensor Module
Operating Voltage Range		5 – 50 Vdc (TYP. 15 Vdc)
Max. Power Consumption		0.6 W (@15Vdc)
Detectable Illumination Range		9.2 – 92 fc (Default : 64 fc) / 100 – 1,000 lx (Default : 500 lx)
LED Light Bi-level Setting		0 % to 30 % (Adjustable) / 10% (Default)
Output Signal		PWM

Junction Box (Optional)

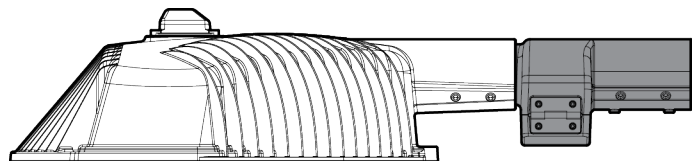
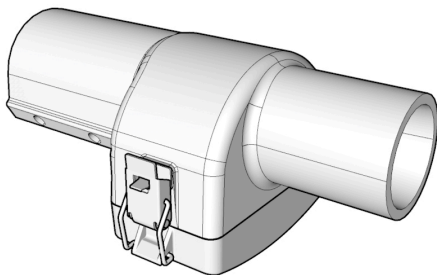

* Supplied accessory for UL product

Ordering Information

Order Code Usage : MT100-A3S50NJG1

MT	000	-	O	OO	OO	O	O	OO
	Power Consumption		Input Voltage	Distribution Type	CCT(K)	Dimming Control	Junction Box	Fixture Color
	100 =100W 130 =130W 150 =150W 180 =180W		A =100~277V B =100~240V	3S =Type III-S	40 =4000 50 =5000	A =Daylight Sensor N =None Z =ZigBee	N =None J =Junction Box	G1 =Gray Powder